



E-CATALOGUE 2023

KITCHEN COUNTERTOP | VANITY COUNTERTOP | WALL CLADDING

PV **SPARTILE**

EXTRA-LARGE FORMAT PORCELAIN PANEL

SPARTILE APPLICATIONS

EXTRA-LARGE FORMATS FOR EXTRAORDINARY IMPRESSIONS

It visually extend the space for an impression of spaciousness and flowing decoration. They are ideal for large space, especially public space.

AUTHENTIC TEXTURES WITH FINE WORKMANSHIP

3D high definition digital technology is used to replicate the authentic textures of marble. Plus a fine touch, delicate gloss and high stability, they are ideal for spaces of different styles.

MORE APPLICATIONS TO INSPIRE CREATIVITY

Different from older products of smaller sizes, the extra-large super stone panels are in various thicknesses, and can be applied to more spaces. Other than indoor and outdoor walls and floors, they can also be used as cupboard panels, table tops and countertops, inspiring creativity of users.

HIGH QUALITY WITH HIGH TECHNOLOGY

Our 16,800 ton presses ensure high density and hardness; world-leading loading process and toughened are used to ensure high breaking strength. Compared to marble, the panels have better physical and chemical properties as well as better resistance to weather, and are good for indoor and outdoor walls and floors.

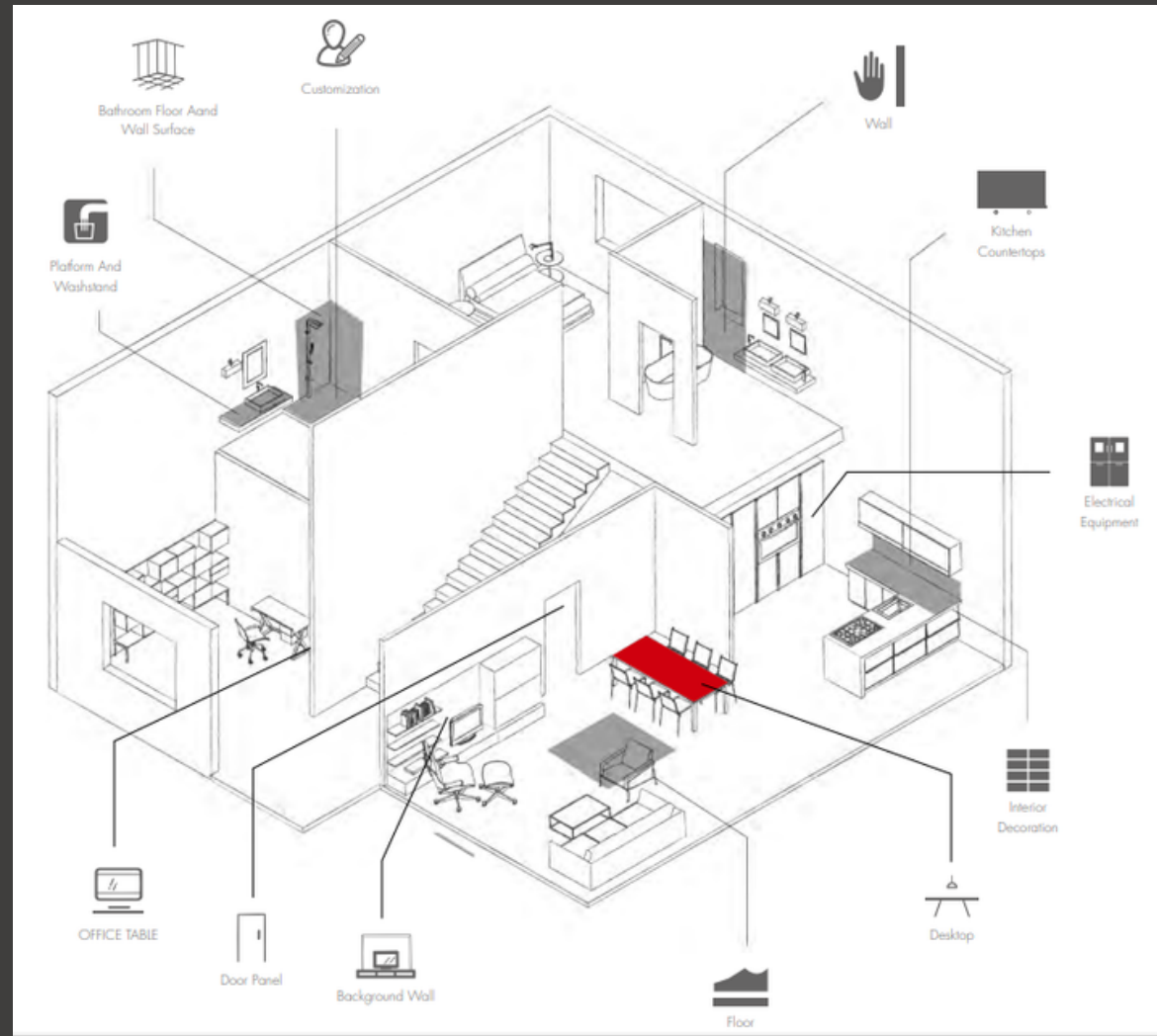

KITCHEN AND VANITY COUNTERTOP WITH BACKSPLASH OPTION

12 MM THICKNESS | RECOMMENDED FOR COUNTERTOP APPLICATION
5.8 MM THICKNESS | RECOMMENDED FOR BACKSPLASH AND WALL APPLICATION

STATUARIO

SPECIFICATIONS:

12mm Thickness | L3200mm x W1600mm slab size | Polished and Matt Finish

5.8mm Thickness | L3200mm x W1600mm slab size | Polished Finish





* ACTUAL SLAB

MAIA



SPECIFICATIONS:

12mm Thickness | L3200mm x W1600mm slab size | Matt Finish





* ACTUAL SLAB

CASTOR

SPECIFICATIONS:

12mm Thickness | L3200mm x W1600mm slab size | Polished and Matt Finish





* ACTUAL SLAB

ELECTRA



SPECIFICATIONS:

12mm Thickness | L3200mm x W1600mm slab size | Polished and Matt Finish





*ACTUAL SLAB

CYRUS

SPECIFICATIONS:

12mm Thickness | L3200mm x W1600mm slab size | Polished Finish

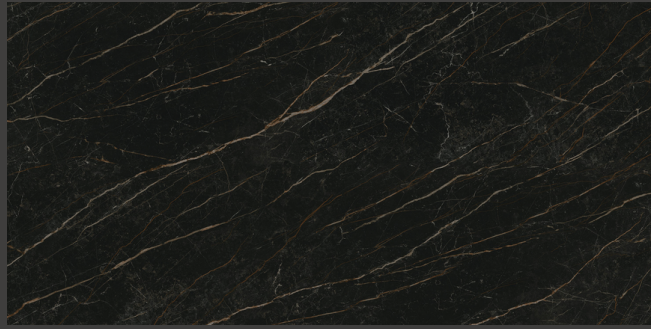



* ACTUAL SLAB

AVIOR



SPECIFICATIONS:

12mm Thickness | L3200mm x W1600mm slab size | Polished and Matt Finish

5.8mm Thickness | L3200mm x W1600mm slab size | Polished Finish





*ACTUAL SLAB



* ACTUAL SLAB

TITANIA

SPECIFICATIONS:

12mm Thickness | L3200mm x W1600mm slab size | Natural Finish





* ACTUAL SLAB

NERO

SPECIFICATIONS:

12mm Thickness | L3200mm x W1600mm slab size | Natural Finish





* ACTUAL SLAB

PLEIA

SPECIFICATIONS:

12mm Thickness | L3200mm x W1600mm slab size | Matt Finish





* ACTUAL SLAB

GRIGIO

SPECIFICATIONS:

12mm Thickness | L3200mm x W1600mm slab size | Polished and Matt Finish





* ACTUAL SLAB

ASTRA



SPECIFICATIONS:

12mm Thickness | L3200mm x W1600mm slab size | Polished and Matt Finish





* ACTUAL SLAB

VESPER



SPECIFICATIONS:
12mm Thickness | L3200mm x W1600mm slab size | Matt Finish





* ACTUAL SLAB

ROYAL

SPECIFICATIONS:

12mm Thickness | L3200mm x W1600mm slab size | Matt Finish





* ACTUAL SLAB

ZENITH



SPECIFICATIONS:

12mm Thickness | L3200mm x W1600mm slab size | Polished Finish





*ACTUAL SLAB

ORION



SPECIFICATIONS:

12mm Thickness | L3200mm x W1600mm slab size | Polished and Matt Finish





*ACTUAL SLAB

HALO



SPECIFICATIONS:

12mm Thickness | L3200mm x W1600mm slab size | Natural Finish





* ACTUAL SLAB

WALL CLADDING WITH BOOKMATCH OPTION

5.8 MM THICKNESS | 12 MM THICKNESS



SPECIFICATIONS:

5.8mm Thickness | L3200mm x W1600mm slab size | Polished Finish

Available in 1,2,3 continuous faces

PATAGON



SPECIFICATIONS:

5.8mm Thickness | L3200mm x W1600mm slab size | Polished Finish

Available in bookmatch

MOON ERA

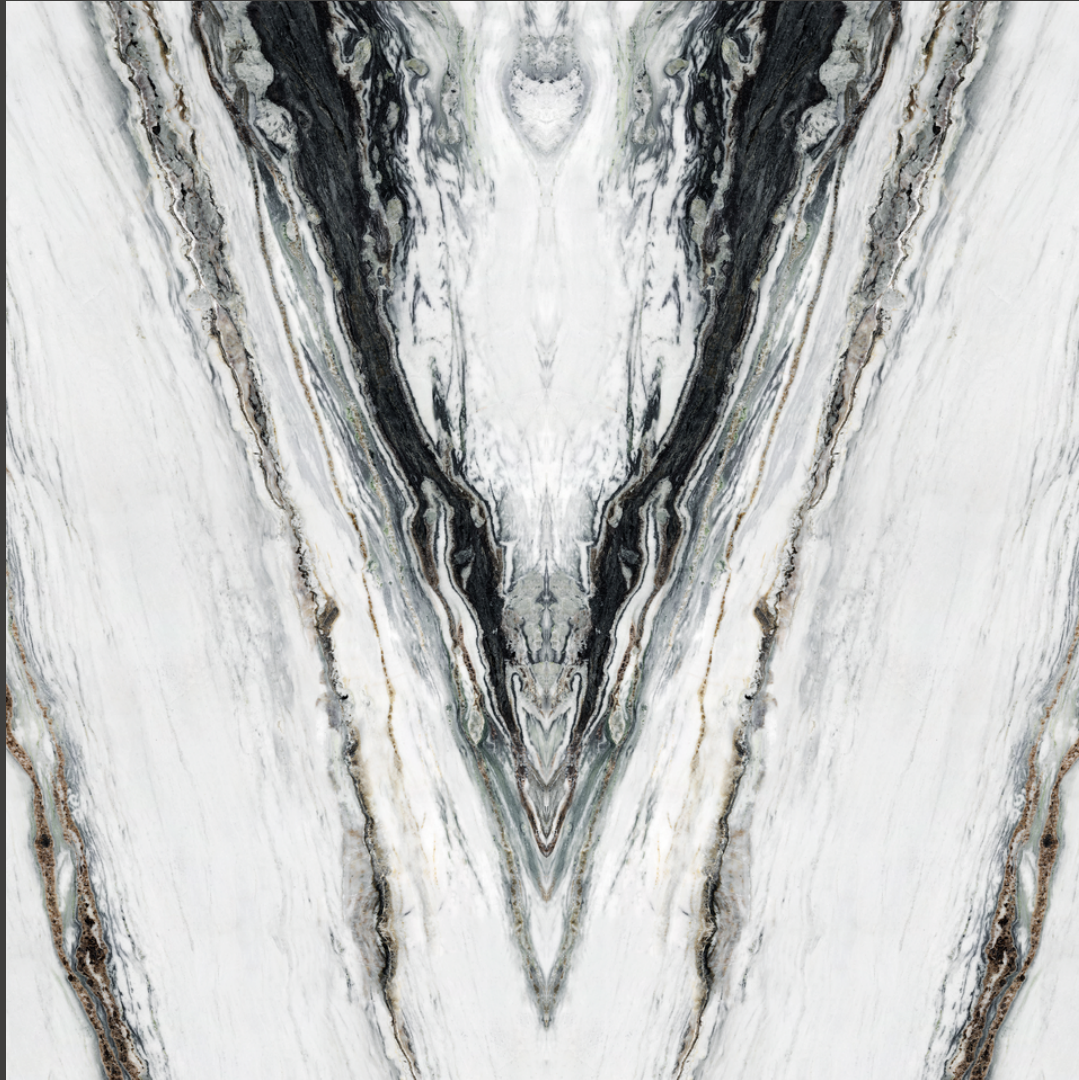

SPECIFICATIONS:

5.8mm Thickness | L3200mm x W1600mm slab size | Polished Finish

12mm Thickness | L3200mm x W1600mm slab size | Polished Finish

Available in bookmatch

AVIOR



SPECIFICATIONS:

5.8mm Thickness | L3200mm x W1600mm slab size | Polished Finish

12mm Thickness | L3200mm x W1600mm slab size | Polished Finish

Available in bookmatch

STATUARIO



SPECIFICATIONS:

12mm Thickness | L3200mm x W1600mm slab size | Polished Finish

Available in bookmatch

VESPER



SPECIFICATIONS:

12mm Thickness | L3200mm x W1600mm slab size | Polished Finish

Available in bookmatch

ZENITH



ON PROJECT SPECIFICATION

THERE ARE MORE OPTIONS FOR OTHER DESIGNS, COLOURS AND FORMATS. PLEASE LET US KNOW YOUR REQUIREMENTS TO ACCOMODATE PROPOSAL AND SAMPLE REQUEST.



POLY VISION PTE LTD

16 TUAS VIEW PLACE SINGAPORE 637862

T: (65) 6569 0566

F: (65) 6569 3603

E: sales@pv.com.sg